

Mi-Fi E5330

User Guide



Issue 2: Dated 9th November 2017

mauritius
telecom

table of contents

- 03** Getting started
- 04** Sending a text
- 05** Top-up your prepay SIM
- 06** Subscribe to a mobile internet package
- 07** Connection problems

Mi-Fi
E5330



Getting started

1. Press & hold the power button of the Mi-Fi until all the indicators light up.
2. Turn on Wi-Fi on your laptop or mobile phone.
3. Select your Mi-Fi's SSID & click on *connect*.
The SSID is printed inside the Mi-Fi's battery cover.
4. Enter the Wi-Fi key.
5. Open a browser & enter 192.168.8.1.
You will be redirected to your Mi-Fi's admin page. The default user name and password is admin.
6. Under settings, ensure that all the profile settings (profile name, user name, password, APN) are set to *my.t*.
7. You're connected!



Sending a text

You can send and receive text messages from your Mi-Fi's admin page.

1. Enter 192.168.8.1 in your browser.
2. On the admin page, select *SMS*.

Ensure you have enough credit on your SIM to send text messages. When you receive a message, the envelope on the display on your Mi-Fi will light up.

Top-up your prepay SIM

Choose the most convenient option to top up your prepay SIM:

- E-Voucher
- Bank ATM
- Recharge by SMS for SBM and MCB customers
- E-Transfer
- my.t mobile online Top Up
- Mobile Money

Subscribe to a mobile internet package

❑ By **SMS**

Send *buy 'Keyword'* on 8684 on the SMS tab of your Mi-Fi's admin page

E.g To buy a Weekly 200MB package, send *buy internetweek1* on 8684

❑ By **Gift Data**

Gift your Mi-Fi device a mobile internet package by sending gift '*keyword*' '*your Mi-Fi's number*' on 8684 from any my.t mobile phone.

E.g To gift a Weekly 200MB package, send gift *internetweek1* '*your Mi-Fi's number*' on 8684

❑ Via **my.t mobile online top-up**

Log in to your online top-up account & select *buy packages* under the *mobile internet* tab.

If you are not registered to online top-up, log on to www.myt.mu/mobile to create an account. It's easy and quick.

For more details, visit www.myt.mu/mobile.

Connection problems

If you're having connection problems or you've forgotten your password or PIN, reset your Mi-Fi device.

To reset:

1. Turn on your Mi-Fi
2. Remove its battery cover. Look for the *Reset* button.

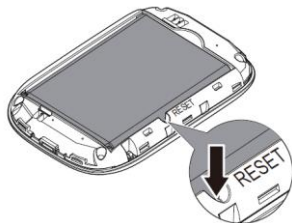

3. Using a pin, press and hold the *Reset* button for five seconds.
4. Your Mi-Fi device will automatically restart.

Default settings will be restored. You can find your Mi-Fi's SSID and Wi-Fi key printed inside your device battery cover.



Need help? Call us on 8900

mauritius
telecom

Issue 2

Dated 9th November 2017