

# Mi-Fi E5330

## User Guide

Issue 1: Dated 7<sup>th</sup> March 2017



mauritius  
telecom

# table of contents

**03** Getting started

**04** Sending a text

**05** Top-up your prepay SIM

**06** Subscribe to a mobile internet package

**07** Connection problems

Mi-Fi  
E5330



# Getting started

1. Press & hold the power button of the Mi-Fi until all the indicators light up.
2. Turn on Wi-Fi on your laptop or mobile phone.
3. Select your Mi-Fi's SSID & click on *connect*.  
The SSID is printed inside the Mi-Fi's battery cover.
4. Enter the Wi-Fi key.
5. Open a browser & enter 192.168.8.1.  
You will be redirected to your Mi-Fi's admin page. The default user name and password is admin.
6. Under settings, ensure that all the profile settings (profile name, user name, password, APN) are set to *orange*.
7. You're connected!



# Sending a text

You can send and receive text messages from your Mi-Fi's admin page.

1. Enter 192.168.8.1 in your browser.
2. On the admin page, select *SMS*.

Ensure you have enough credit on your SIM to send text messages. When you receive a message, the envelope on the display on your Mi-Fi will light up.

# Top-up your prepay SIM

Choose the most convenient option to top up your prepay SIM:

- E-Voucher
- Bank ATM
- Recharge by SMS for SBM and MCB customers
- E-Transfer
- Orange Money
- Online top-up

# Subscribe to a mobile internet package

## ❑ By **SMS**

Send *buy 'Keyword'* on 8684 on the SMS tab of your Mi-Fi's admin page

E.g To buy a Weekly 200MB package, send *buy internetweek1* on 8684

## ❑ By **Gift Data**

Gift your Mi-Fi device a mobile internet package by sending gift *'keyword' 'your Mi-Fi's number'* on 8684 from any Orange mobile phone.

E.g To gift a Weekly 200MB package, send gift *internetweek1 'your Mi-Fi's number'* on 8684

## ❑ Via **Online top-up**

Log in to your online top-up account & select *buy packages* under the *mobile internet* tab.

If you are not registered to online top-up, log on to [www.orange.mu](http://www.orange.mu) to create an account. It's easy and quick.

For more details, visit [www.orange.mu](http://www.orange.mu).

# Connection problems

If you're having connection problems or you've forgotten your password or PIN, reset your Mi-Fi device.

To reset:

1. Turn on your Mi-Fi
2. Remove its battery cover. Look for the *Reset* button.

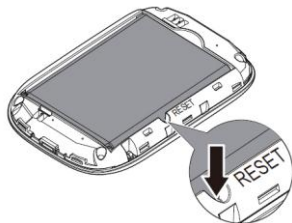

3. Using a pin, press and hold the *Reset* button for five seconds.
4. Your Mi-Fi device will automatically restart.

Default settings will be restored. You can find your Mi-Fi's SSID and Wi-Fi key printed inside your device battery cover.



**Need help? Call us on 8900**

**mauritius**  
**telecom**

**Issue 1**

**Dated 7<sup>th</sup> March 2017**